

Enbrighten Zigbee In-Wall Smart Switch

enbrighten®

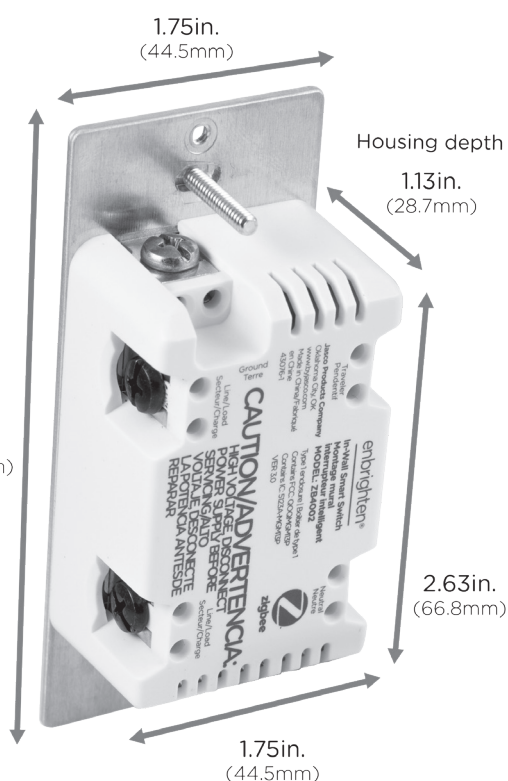

Specifications

Power: 120VAC, 60Hz **Signal Frequency:** 2.4GHz

Maximum Load: 960W incandescent, 1/2 HP Motor 1800W (15A) resistive

Range: Up to 150ft. from controller or closest Zigbee device

Operating Temperature: 32-104° F (0-40° C)

Warranty: 5-year limited product warranty

Requires neutral wire. Switch must be mounted indoors

Design Features

- QuickFit™ — improved components reduce the housing depth by up to 20% compared to previous Zigbee models and eliminated the need for heat tabs
- SimpleWire™ — auto-sensing load/line terminals support fast installation by detecting line and load wires and configuring the switch accordingly
- Turn ON/OFF manually or remotely via Zigbee controller
- Can be included in multiple groups and scenes
- May be used in single-pole installation or with up to four add-on switches (12723/46199)
- Interchangeable paddle — white & light almond in package
- Over-the-air updates — once joined to your Zigbee network, the smart dimmer can automatically receive updates through your Zigbee gateway
- Uses a standard, rocker-style wallplate for single-gang installations (wallplate not included)
- Blue LED indicates smart switch location in a dark room (LED can be enabled/disabled manually)
- LED status indicator — indicates smart switch scanning during pairing process
- Zigbee 3.0 certified for simple pairing and integrated home automation
- Screw terminal installation — requires wiring connections for line (hot), load, neutral, and ground. Traveler wire required for multi-switch installation

Zigbee Features

- Effortless device pairing to Zigbee certified gateways
- Backward compatible with all generations of Zigbee devices
- Supports wireless upgrades to future-proof your home

White/light almond paddles included



* Requires Zigbee hub or controller — functions may vary depending on brand

Single-Location Wiring

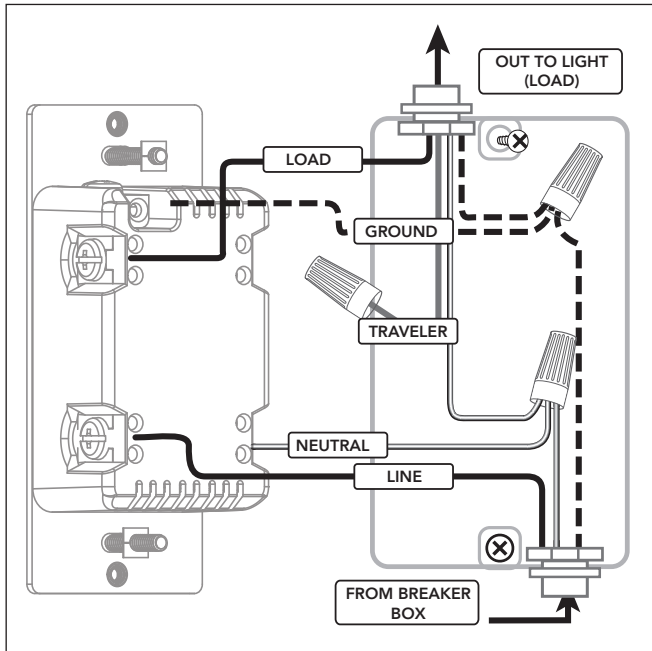

Space-Saving Screw Terminals

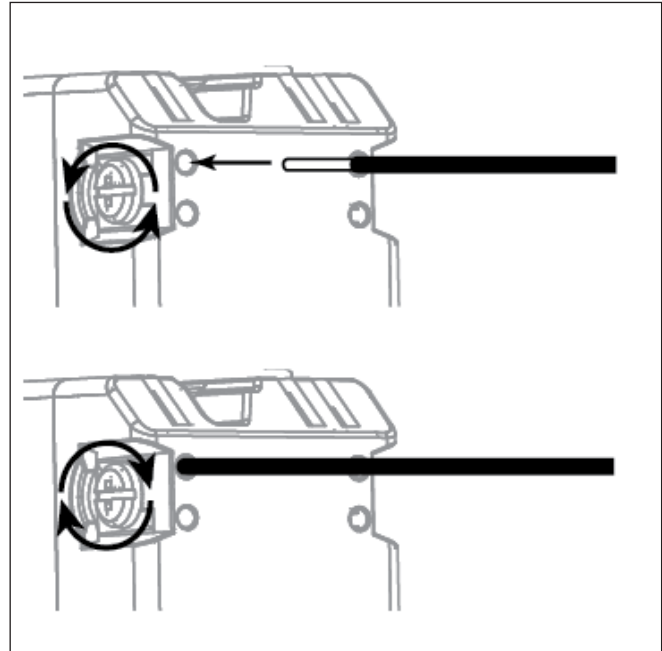

Multi-Location Wiring

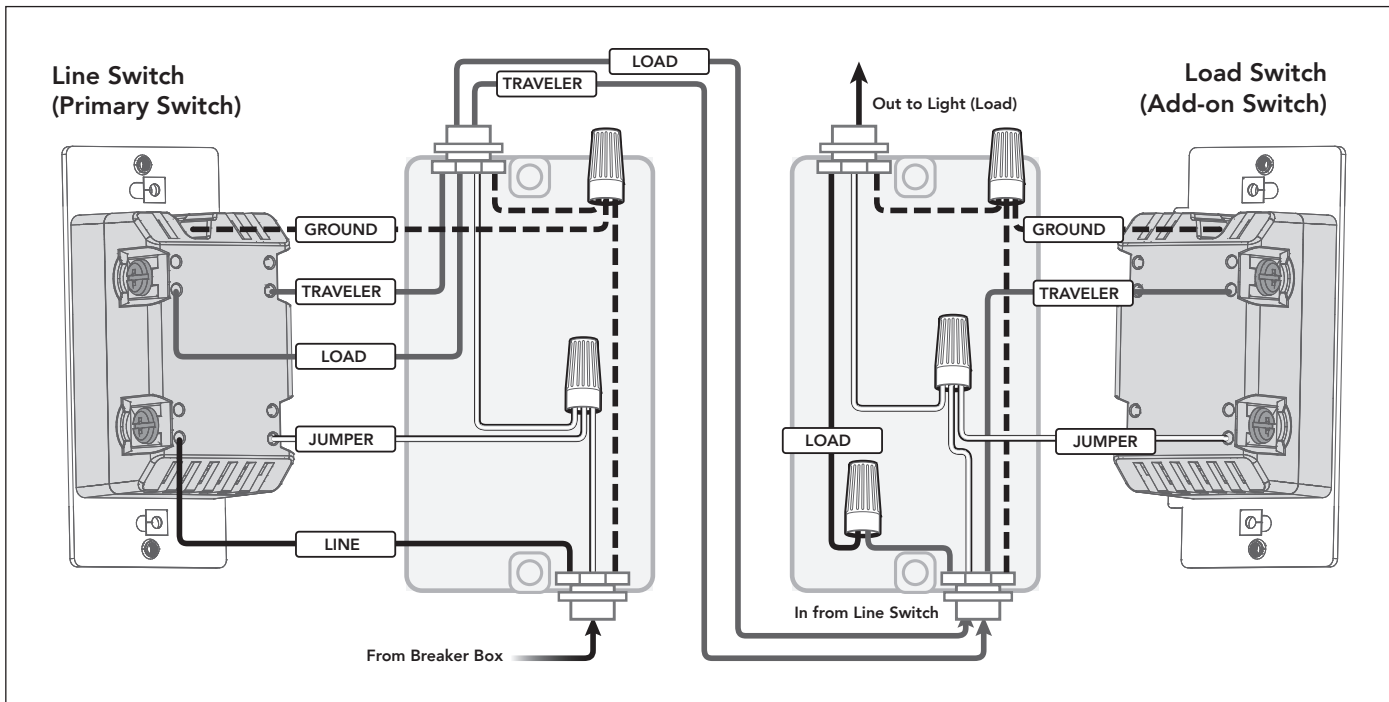

Installation Recommendations

- Devices require a single-gang U.S. wall box – 3½in. deep recommended, 2¼in. deep minimum
- Insert wires into holes, do not wrap wires around screws. Do not remove screws.
- Indoor installation only
- Visit ezzigbee.com/hubs for hub compatibility
- Wallplates sold separately
- Trilingual instruction manual – English, French, Spanish

Device Configuration

Adding your devices to a Zigbee network

Once the hub is ready to add the smart switch, pairing begins automatically when power is supplied. The switch appears in the controller's menu when paired.

To remove and reset the device

Choose to remove the lighting device as instructed by your hub. The controller indicates the smart switch was removed.

To return to factory defaults

Quickly press the top rocker 10 times.

Certifications & Compliances



Compliances, specifications and availability are subject to change without notice

Distributed by Jasco Products Company LLC
10 E. Memorial Rd., Oklahoma City, OK

©Jasco 2020

Related Products – Enbrighten Zigbee Smart Controls



43096
Plug-In
Dual-Outlet
Smart Dimmer



43094
Plug-In
Dual-Outlet
Smart Switch



43100
Plug-in
Outdoor
Smart Switch



43077
In-Wall
Smart Switch,
Paddle 120/277



43084
In-Wall Smart
Switch, Toggle



43080
In-Wall
Smart Dimmer,
Paddle



43090
In-Wall
Smart Dimmer,
Toggle



43102
In-Wall
Smart Outlet



46199
In-Wall Add-on
Switch, Paddle



46200
In-Wall Add-On
Switch, Toggle



35183
Black Paddle



35184
Brown Paddle



35185
Ivory Paddle



35360
Light Almond
Paddle



47203
White Paddle